

Professionals in temporary structure design and earthwork structure design respond from planning to calculation, drawing, and integration.

We have more than 200 trading results in Japan and overseas, including China and Vietnam.

## Temporary Structure Design

We design earth retaining support construction, temporary shutoff construction using steel earth retaining materials, and high-strength earth retaining main materials (Hirose Mega Beam / Hirose Twin Beam). By partnering with overseas design companies, it is also possible to immediately respond to disaster recovery construction work etc.

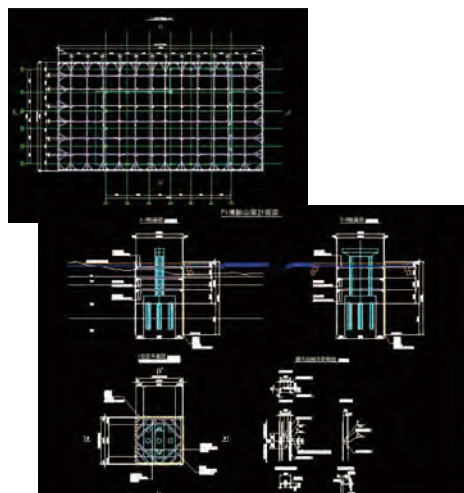

We design temporary piers and gantries using bridge products, such as pre-girder bridges, KD bridges (truss bridges), and G pilled jetty, including H-section steel girders. Through the operation of the bridge automatic drafting / calculation system, we are working to further improve quality and productivity.

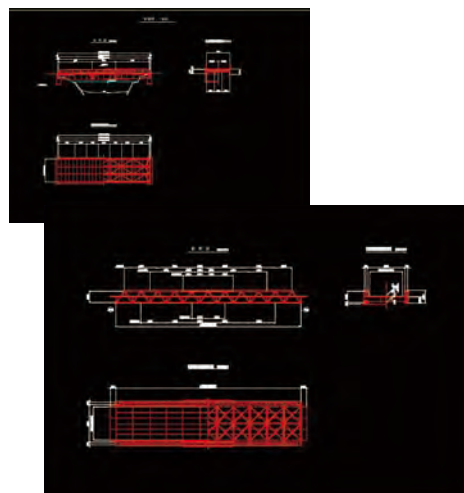

## Earthwork Structure Design

We design reinforced earth walls (Terre Armee), arch culverts (TechSpan), and large blocks (NSS block) using precast concrete products. Reinforcing earth walls are also compared with the major construction methods.

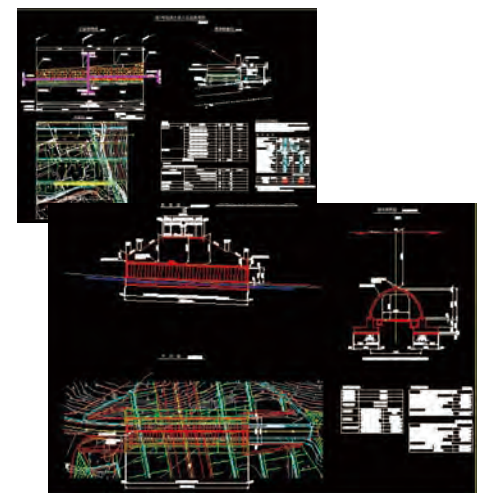

As a design professional group engaged in temporary structures and earthwork structures, which are essential to social infrastructure development, we aim to be a company that continues to be relied on by customers who plan for them.

### 3D-CAD

With the promotion of BIM/CIM by the MLIT, we are introducing and utilizing 3D-CAD. In addition, 3D-CAD is also utilized as a training material for in-house education, such as reproducing the earth retaining material assembly drawing described in the Nikkenstar Steel Earth Retaining Material General Catalog in 3D.

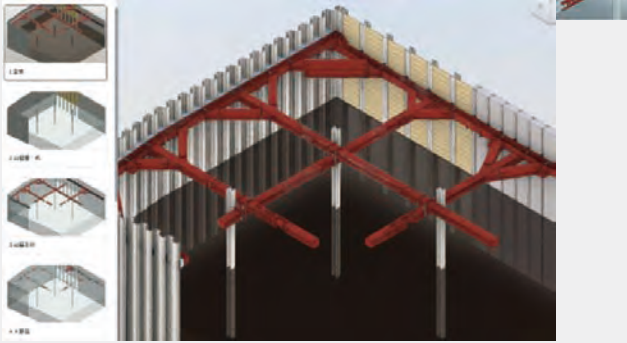

### Development of Bridge Automatic Drafting / Calculation System

In order to respond to the diversification and complexity of bridge products in recent years, we have developed a bridge automatic drafting / calculation system. With the development and operation start of the system, it has become possible to simplify structure selection (standardization by programs) and to improve efficiency by automatic drafting (achievement of quick delivery).

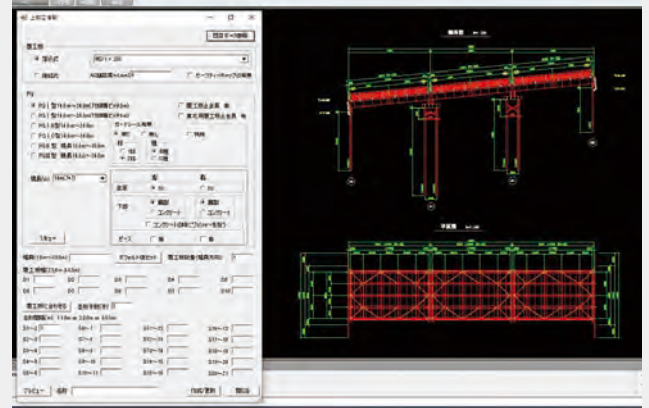

### Efforts for Quality Improvement

We hold in-house workshops to present information and experiences useful for operations. In addition, various efforts are performed for quality improvement, such as the maintenance and restructuring of training manuals for in-house education, and technical guidance for overseas partner companies.



Training Handbook

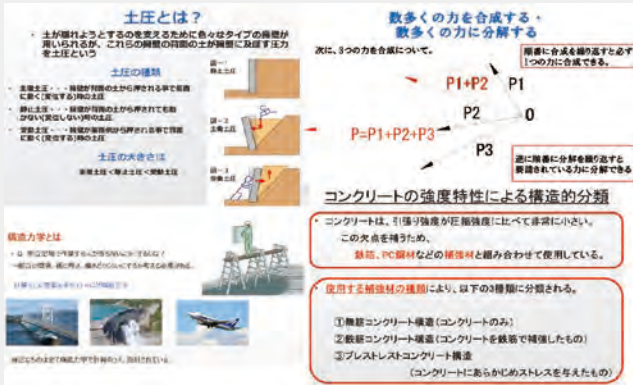

※Inside of handbook ex What is Soil pressure?

### Cleaning Activity Around Company

For the purpose of improving the local environment, we are working on the cleaning activity around our company once a week. Aiming for a company that can contribute to society through activities, we are searching for new efforts on a daily basis.



### Company Profile

Company name	Caddec Co., Ltd.	President	Jun Nagatomo
Founded	April 11, 1989		
Capital	90 million yen		
Number of employees	64 people	Description of Business	<ul style="list-style-type: none"> <li>Design and drafting of temporary structures</li> <li>Design and drafting of earthwork structures</li> <li>Consulting concerning civil engineering work</li> </ul>
Head office	2-1-2 Gakuen Kibanadai-Nishi Miyazaki City Miyazaki 889-2155 Japan TEL +81-985-58-1211 FAX +81-985-58-2131		